

## **Abbey Grill – Application for a premises licence**

### **Bundle for hearing on the 1<sup>st</sup> December 2020**

- Application for the premises licence
- DPS consent
- Plan of the premises
- Blue Notice
- Newspaper advert
- Objection from Essex Police
- Response from Environmental Health
- Response from Essex County Fire & Rescue Service
- Map of the area

# Application for the premises licence



**Epping Forest**  
**Application for a premises licence**  
**Licensing Act 2003**

For help contact  
[licensing@eppingforestdc.gov.uk](mailto:licensing@eppingforestdc.gov.uk)  
Telephone: 01992 564000

\* required information

## Section 1 of 21

You can save the form at any time and resume it later. You do not need to be logged in when you resume.

System reference  This is the unique reference for this application generated by the system.

Your reference  You can put what you want here to help you track applications if you make lots of them. It is passed to the authority.

Are you an agent acting on behalf of the applicant?

Yes  No

Put "no" if you are applying on your own behalf or on behalf of a business you own or work for.

### Applicant Details

\* First name

\* Family name

\* E-mail

Main telephone number   Include country code.

Other telephone number

Indicate here if the applicant would prefer not to be contacted by telephone

Is the applicant:

Applying as a business or organisation, including as a sole trader

Applying as an individual

A sole trader is a business owned by one person without any special legal structure. Applying as an individual means the applicant is applying so the applicant can be employed, or for some other personal reason, such as following a hobby.

### Applicant Business

Is the applicant's business registered in the UK with Companies House?  Yes  No

Note: completing the Applicant Business section is optional in this form.

Registration number

Business name  If the applicant's business is registered, use its registered name.

VAT number   Put "none" if the applicant is not registered for VAT.

Legal status

Continued from previous page...

Applicant's position in the business

Home country

The country where the applicant's headquarters are.

**Registered Address**

Address registered with Companies House.

Building number or name

Street

District

City or town

County or administrative area

Postcode

Country

**Agent Details**

\* First name

\* Family name

\* E-mail

Main telephone number

Include country code.

Other telephone number

Indicate here if you would prefer not to be contacted by telephone

Are you:

- An agent that is a business or organisation, including a sole trader
- A private individual acting as an agent

A sole trader is a business owned by one person without any special legal structure.

**Agent Business**

Is your business registered in the UK with Companies House?  Yes  No

Note: completing the Applicant Business section is optional in this form.

Registration number

Business name

If your business is registered, use its registered name.

VAT number

Put "none" if you are not registered for VAT.

Legal status

Continued from previous page...

Your position in the business	<input type="text" value="consultant"/>	
Home country	<input type="text" value="United Kingdom"/>	The country where the headquarters of your business is located.
<b>Agent Registered Address</b>		Address registered with Companies House.
Building number or name	<input type="text" value=""/>	
Street	<input type="text" value="Bosgrove"/>	
District	<input type="text" value=""/>	
City or town	<input type="text" value="London"/>	
County or administrative area	<input type="text" value=""/>	
Postcode	<input type="text" value="E4 6QT"/>	
Country	<input type="text" value="United Kingdom"/>	

**Section 2 of 21**

**PREMISES DETAILS**

I/we, as named in section 1, apply for a premises licence under section 17 of the Licensing Act 2003 for the premises described in section 2 below (the premises) and I/we are making this application to you as the relevant licensing authority in accordance with section 12 of the Licensing Act 2003.

**Premises Address**

Are you able to provide a postal address, OS map reference or description of the premises?

- Address     OS map reference     Description

**Postal Address Of Premises**

Building number or name	<input type="text" value="18"/>
Street	<input type="text" value="Sun Street"/>
District	<input type="text" value=""/>
City or town	<input type="text" value="Waltham Abbey"/>
County or administrative area	<input type="text" value="Essex"/>
Postcode	<input type="text" value="EN9 1EE"/>
Country	<input type="text" value="United Kingdom"/>

**Further Details**

Telephone number	<input type="text" value=""/>
Non-domestic rateable value of premises (£)	<input type="text" value="13,000"/>

## APPLICATION DETAILS

In what capacity are you applying for the premises licence?

- An individual or individuals
- A limited company / limited liability partnership
- A partnership (other than limited liability)
- An unincorporated association
- Other (for example a statutory corporation)
- A recognised club
- A charity
- The proprietor of an educational establishment
- A health service body
- A person who is registered under part 2 of the Care Standards Act 2000 (c14) in respect of an independent hospital in Wales
- A person who is registered under Chapter 2 of Part 1 of the Health and Social Care Act 2008 in respect of the carrying on of a regulated activity (within the meaning of that Part) in an independent hospital in England
- The chief officer of police of a police force in England and Wales

### Confirm The Following

- I am carrying on or proposing to carry on a business which involves the use of the premises for licensable activities
- I am making the application pursuant to a statutory function
- I am making the application pursuant to a function discharged by virtue of Her Majesty's prerogative

## Section 4 of 21

### NON INDIVIDUAL APPLICANTS

Provide name and registered address of applicant in full. Where appropriate give any registered number. In the case of a partnership or other joint venture (other than a body corporate), give the name and address of each party concerned.

#### Non Individual Applicant's Name

Name

ARIN Restaurant LTD

#### Details

Registered number (where applicable)

12698810

Description of applicant (for example partnership, company, unincorporated association etc)

Continued from previous page...

Private Limited Company

**Address**

Building number or name

Street

District

City or town

County or administrative area

Postcode

Country

**Contact Details**

E-mail

Telephone number

Other telephone number

\* Date of birth

dd mm yyyy

\* Nationality  [Documents that demonstrate entitlement to work in the UK](#)

**Section 5 of 21**

**OPERATING SCHEDULE**

When do you want the premises licence to start?  /  /

dd mm yyyy

If you wish the licence to be valid only for a limited period, when do you want it to end  /  /

dd mm yyyy

Provide a general description of the premises

For example the type of premises, its general situation and layout and any other information which could be relevant to the licensing objectives. Where your application includes off-supplies of alcohol and you intend to provide a place for consumption of these off- supplies you must include a description of where the place will be and its proximity to the premises.

*Continued from previous page...*

If 5,000 or more people are expected to attend the premises at any one time, state the number expected to attend

**Section 6 of 21**

**PROVISION OF PLAYS**

[See guidance on regulated entertainment](#)

Will you be providing plays?

- Yes  No

**Section 7 of 21**

**PROVISION OF FILMS**

[See guidance on regulated entertainment](#)

Will you be providing films?

- Yes  No

**Section 8 of 21**

**PROVISION OF INDOOR SPORTING EVENTS**

[See guidance on regulated entertainment](#)

Will you be providing indoor sporting events?

- Yes  No

**Section 9 of 21**

**PROVISION OF BOXING OR WRESTLING ENTERTAINMENTS**

[See guidance on regulated entertainment](#)

Will you be providing boxing or wrestling entertainments?

- Yes  No

**Section 10 of 21**

**PROVISION OF LIVE MUSIC**

[See guidance on regulated entertainment](#)

Will you be providing live music?

- Yes  No

**Section 11 of 21**

**PROVISION OF RECORDED MUSIC**

[See guidance on regulated entertainment](#)

Will you be providing recorded music?

- Yes  No

**Section 12 of 21**

**PROVISION OF PERFORMANCES OF DANCE**

[See guidance on regulated entertainment](#)

Will you be providing performances of dance?

Continued from previous page...

**Section 13 of 21**

**PROVISION OF ANYTHING OF A SIMILAR DESCRIPTION TO LIVE MUSIC, RECORDED MUSIC OR PERFORMANCES OF DANCE**

[See guidance on regulated entertainment](#)

Will you be providing anything similar to live music, recorded music or performances of dance?

Yes  No

**Section 14 of 21**

**LATE NIGHT REFRESHMENT**

Will you be providing late night refreshment?

Yes  No

**Standard Days And Timings**

MONDAY

Start

End

Start

End

Give timings in 24 hour clock.  
(e.g., 16:00) and only give details for the days  
of the week when you intend the premises  
to be used for the activity.

TUESDAY

Start

End

Start

End

WEDNESDAY

Start

End

Start

End

THURSDAY

Start

End

Start

End

FRIDAY

Start

End

Start

End

SATURDAY

Start

End

Start

End

SUNDAY

Start

End

Start

End



Continued from previous page...

Will the provision of late night refreshment take place indoors or outdoors or both?

- Indoors                       Outdoors                       Both

Where taking place in a building or other structure tick as appropriate. Indoors may include a tent.

State type of activity to be authorised, if not already stated, and give relevant further details, for example (but not exclusively) whether or not music will be amplified or unamplified.

provision of hot food and drink consistent with the operation of a restaurant. Whilst current regulations limit the operational hours nothing in this application should be seen as seeking to override any restrictions. Therefore whilst the regulations require the premises to close at a specific time the premises will comply and consequently after 22:00 the premises will only deliver to customers off the premises in response to orders placed online, by phone or by post. the hours specified in the application will apply should a licence be granted and the regulations be repealed/varied.

State any seasonal variations

For example (but not exclusively) where the activity will occur on additional days during the summer months.

Non-standard timings. Where the premises will be used for the supply of late night refreshments at different times from those listed in the column on the left, list below

For example (but not exclusively), where you wish the activity to go on longer on a particular day e.g. Christmas Eve.

New years eve 23:00 to 01:00 day following

## Section 15 of 21

### SUPPLY OF ALCOHOL

Will you be selling or supplying alcohol?

- Yes                       No

#### Standard Days And Timings

MONDAY

Start

End

Start

End

Give timings in 24 hour clock. (e.g., 16:00) and only give details for the days of the week when you intend the premises to be used for the activity.

TUESDAY

Start

End

Start

End

Continued from previous page...

WEDNESDAY

Start 10:00

End 00:00

Start

End

THURSDAY

Start 10:00

End 00:00

Start

End

FRIDAY

Start 10:00

End 00:00

Start

End

SATURDAY

Start 10:00

End 00:00

Start

End

SUNDAY

Start 10:00

End 00:00

Start

End

Will the sale of alcohol be for consumption:

- On the premises     Off the premises     Both

If the sale of alcohol is for consumption on the premises select on, if the sale of alcohol is for consumption away from the premises select off. If the sale of alcohol is for consumption on the premises and away from the premises select both.

State any seasonal variations

For example (but not exclusively) where the activity will occur on additional days during the summer months.

Non-standard timings. Where the premises will be used for the supply of alcohol at different times from those listed in the column on the left, list below

For example (but not exclusively), where you wish the activity to go on longer on a particular day e.g. Christmas Eve.

New Years Eve 10:00 to 01:00 day following

State the name and details of the individual whom you wish to specify on the licence as premises supervisor

Continued from previous page...

**Name**

First name

Family name

Date of birth   
dd mm yyyy

**Enter the contact's address**

Building number or name

Street

District

City or town

County or administrative area

Postcode

Country

Personal Licence number (if known)

Issuing licensing authority (if known)

**PROPOSED DESIGNATED PREMISES SUPERVISOR CONSENT**

How will the consent form of the proposed designated premises supervisor be supplied to the authority?

- Electronically, by the proposed designated premises supervisor
- As an attachment to this application

Reference number for consent form (if known)

If the consent form is already submitted, ask the proposed designated premises supervisor for its 'system reference' or 'your reference'.

**Section 16 of 21**

**ADULT ENTERTAINMENT**

Highlight any adult entertainment or services, activities, or other entertainment or matters ancillary to the use of the premises that may give rise to concern in respect of children

Give information about anything intended to occur at the premises or ancillary to the use of the premises which may give rise to concern in respect of children, regardless of whether you intend children to have access to the premises, for example (but not exclusively) nudity or semi-nudity, films for restricted age groups etc gambling machines etc.

None

Continued from previous page...

Section 17 of 21

HOURS PREMISES ARE OPEN TO THE PUBLIC

Standard Days And Timings

MONDAY

Start

End

Start

End

Give timings in 24 hour clock.  
(e.g., 16:00) and only give details for the days  
of the week when you intend the premises  
to be used for the activity.

TUESDAY

Start

End

Start

End

WEDNESDAY

Start

End

Start

End

THURSDAY

Start

End

Start

End

FRIDAY

Start

End

Start

End

SATURDAY

Start

End

Start

End

SUNDAY

Start

End

Start

End

State any seasonal variations

For example (but not exclusively) where the activity will occur on additional days during the summer months.

Non standard timings. Where you intend to use the premises to be open to the members and guests at different times from those listed in the column on the left, list below

For example (but not exclusively), where you wish the activity to go on longer on a particular day e.g. Christmas Eve.

new years eve - 10:00 to 01:30 day following

Continued from previous page...

--

**Section 18 of 21**

**LICENSING OBJECTIVES**

Describe the steps you intend to take to promote the four licensing objectives:

a) General – all four licensing objectives (b,c,d,e)

List here steps you will take to promote all four licensing objectives together.

The premises will operate as a restaurant and bar. Customers will be seated at a table or the bar and service will be waiter / waitress. See Annex A for proposed conditions.  
Whilst current regulations limit the operational hours nothing in this application should be seen as seeking to override any restrictions. Therefore whilst the regulations require the premises to close at a specific time the premises will comply and consequently after 22:00 the premises will only deliver food and drink to customers off the premises in response to orders placed online, by phone or by post

b) The prevention of crime and disorder

see a
-------

c) Public safety

see a
-------

d) The prevention of public nuisance

see a
-------

e) The protection of children from harm

see a
-------

**Section 19 of 21**

**NOTES ON DEMONSTRATING ENTITLEMENT TO WORK IN THE UK**



*Continued from previous page...*

**Entitlement to work/immigration status for individual applicants and applications from partnerships which are not limited liability partnerships:**

A licence may not be held by an individual or an individual in a partnership who is resident in the UK who:

- does not have the right to live and work in the UK; or
- is subject to a condition preventing him or her from doing work relating to the carrying on of a licensable activity.

Any premises licence issued in respect of an application made on or after 6 April 2017 will become invalid if the holder ceases to be entitled to work in the UK.

Applicants must demonstrate that they have an entitlement to work in the UK and are not subject to a condition preventing them from doing work relating to the carrying on of a licensable activity. They do this in one of two ways: 1) by providing with this application copies or scanned copies of the documents listed below (which do not need to be certified), or 2) by providing their 'share code' to enable the licensing authority to carry out a check using the Home Office online right to work checking service (see below).

**Documents which demonstrate entitlement to work in the UK**

- An expired or current passport showing the holder, or a person named in the passport as the child of the holder, is a British citizen or a citizen of the UK and Colonies having the right of abode in the UK [please see note below about which sections of the passport to copy].
- An expired or current passport or national identity card showing the holder, or a person named in the passport as the child of the holder, is a national of a European Economic Area country or Switzerland.
- A Registration Certificate or document certifying permanent residence issued by the Home Office to a national of a European Economic Area country or Switzerland.
- A Permanent Residence Card issued by the Home Office to the family member of a national of a European Economic Area country or Switzerland.
- A **current** Biometric Immigration Document (Biometric Residence Permit) issued by the Home Office to the holder indicating that the person named is allowed to stay indefinitely in the UK, or has no time limit on their stay in the UK.
- A **current** passport endorsed to show that the holder is exempt from immigration control, is allowed to stay indefinitely in the UK, has the right of abode in the UK, or has no time limit on their stay in the UK.
- A **current** Immigration Status Document issued by the Home Office to the holder with an endorsement indicating that the named person is allowed to stay indefinitely in the UK or has no time limit on their stay in the UK, **when produced in combination with** an official document giving the person's permanent National Insurance number and their name issued by a Government agency or a previous employer.
- A birth or adoption certificate issued in the UK, **when produced in combination with** an official document giving the person's permanent National Insurance number and their name issued by a Government agency or a previous employer.
- A birth or adoption certificate issued in the Channel Islands, the Isle of Man or Ireland **when produced in combination with** an official document giving the person's permanent National Insurance number and their name issued by a Government agency or a previous employer.
- A certificate of registration or naturalisation as a British citizen, **when produced in combination with** an official document giving the person's permanent National Insurance number and their name issued by a Government agency or a previous employer.

*Continued from previous page...*

- A **current** passport endorsed to show that the holder is allowed to stay in the UK and is currently allowed to work and is not subject to a condition preventing the holder from doing work relating to the carrying on of a licensable activity.
- A **current** Biometric Immigration Document (Biometric Residence Permit) issued by the Home Office to the holder which indicates that the named person can currently stay in the UK and is allowed to work relation to the carrying on of a licensable activity.
- A **current** Residence Card issued by the Home Office to a person who is not a national of a European Economic Area state or Switzerland but who is a family member of such a national or who has derivative rights or residence.
- A **current** Immigration Status Document containing a photograph issued by the Home Office to the holder with an endorsement indicating that the named person may stay in the UK, and is allowed to work and is not subject to a condition preventing the holder from doing work relating to the carrying on of a licensable activity **when produced in combination with** an official document giving the person's permanent National Insurance number and their name issued by a Government agency or a previous employer.
- A Certificate of Application, **less than 6 months old**, issued by the Home Office under regulation 18(3) or 20(2) of the Immigration (European Economic Area) Regulations 2016, to a person who is not a national of a European Economic Area state or Switzerland but who is a family member of such a national or who has derivative rights of residence.
- Reasonable evidence that the person has an outstanding application to vary their permission to be in the UK with the Home Office such as the Home Office acknowledgement letter or proof of postage evidence, or reasonable evidence that the person has an appeal or administrative review pending on an immigration decision, such as an appeal or administrative review reference number.
- Reasonable evidence that a person who is not a national of a European Economic Area state or Switzerland but who is a family member of such a national or who has derivative rights of residence in exercising treaty rights in the UK including:-
  - evidence of the applicant's own identity – such as a passport,
  - evidence of their relationship with the European Economic Area family member – e.g. a marriage certificate, civil partnership certificate or birth certificate, and
  - evidence that the European Economic Area national has a right of permanent residence in the UK or is one of the following if they have been in the UK for more than 3 months:
    - (i) working e.g. employment contract, wage slips, letter from the employer,
    - (ii) self-employed e.g. contracts, invoices, or audited accounts with a bank,
    - (iii) studying e.g. letter from the school, college or university and evidence of sufficient funds; or
    - (iv) self-sufficient e.g. bank statements.

Family members of European Economic Area nationals who are studying or financially independent must also provide evidence that the European Economic Area national and any family members hold comprehensive sickness insurance in the UK. This can include a private medical insurance policy, an EHIC card or an S1, S2 or S3 form.

**Original documents must not be sent to licensing authorities.** If the document copied is a passport, a copy of the following pages should be provided:-

- (i) any page containing the holder's personal details including nationality;
- (ii) any page containing the holder's photograph;
- (iii) any page containing the holder's signature;
- (iv) any page containing the date of expiry; and
- (v) any page containing information indicating the holder has permission to enter or remain in the UK and is permitted to work.

*Continued from previous page...*

If the document is not a passport, a copy of the whole document should be provided.

Your right to work will be checked as part of your licensing application and this could involve us checking your immigration status with the Home Office. We may otherwise share information with the Home Office. Your licence application will not be determined until you have complied with this guidance.

#### **Home Office online right to work checking service**

As an alternative to providing a copy of the documents listed above, applicants may demonstrate their right to work by allowing the licensing authority to carry out a check with the Home Office online right to work checking service.

To demonstrate their right to work via the Home Office online right to work checking service, applicants should include in this application their 9-digit share code (provided to them upon accessing the service at <https://www.gov.uk/prove-right-to-work>) which, along with the applicant's date of birth (provided within this application), will allow the licensing authority to carry out the check.

In order to establish the applicant's right to work, the check will need to indicate that the applicant is allowed to work in the United Kingdom and is not subject to a condition preventing them from doing work relating to the carrying on of a licensable activity.

An online check will not be possible in all circumstances because not all applicants will have an immigration status that can be checked online. The Home Office online right to work checking service sets out what information and/or documentation applicants will need in order to access the service. Applicants who are unable to obtain a share code from the service should submit copy documents as set out above.

**Section 20 of 21**

**NOTES ON REGULATED ENTERTAINMENT**



*Continued from previous page...*

In terms of specific **regulated entertainments** please note that:

- Plays: no licence is required for performances between 08:00 and 23:00 on any day, provided that the audience does not exceed 500.
- Films: no licence is required for 'not-for-profit' film exhibition held in community premises between 08:00 and 23:00 on any day provided that the audience does not exceed 500 and the organiser (a) gets consent to the screening from a person who is responsible for the premises; and (b) ensures that each such screening abides by age classification ratings.
- Indoor sporting events: no licence is required for performances between 08:00 and 23:00 on any day, provided that the audience does not exceed 1000.
- Boxing or Wrestling Entertainment: no licence is required for a contest, exhibition or display of Greco-Roman wrestling, or freestyle wrestling between 08:00 and 23:00 on any day, provided that the audience does not exceed 1000. Combined fighting sports – defined as a contest, exhibition or display which combines boxing or wrestling with one or more martial arts – are licensable as a boxing or wrestling entertainment rather than an indoor sporting event.
- Live music: no licence permission is required for:
  - o a performance of unamplified live music between 08:00 and 23:00 on any day, on any premises.
  - o a performance of amplified live music between 08:00 and 23:00 on any day on premises authorised to sell alcohol for consumption on those premises, provided that the audience does not exceed 500.
  - o a performance of amplified live music between 08:00 and 23:00 on any day, in a workplace that is not licensed to sell alcohol on those premises, provided that the audience does not exceed 500.
  - o a performance of amplified live music between 08:00 and 23:00 on any day, in a church hall, village hall, community hall, or other similar community premises, that is not licensed by a premises licence to sell alcohol, provided that (a) the audience does not exceed 500, and (b) the organiser gets consent for the performance from a person who is responsible for the premises.
  - o a performance of amplified live music between 08:00 and 23:00 on any day, at the non-residential premises of (i) a local authority, or (ii) a school, or (iii) a hospital, provided that (a) the audience does not exceed 500, and (b) the organiser gets consent for the performance on the relevant premises from: (i) the local authority concerned, or (ii) the school or (iii) the health care provider for the hospital.
- Recorded Music: no licence permission is required for:
  - o any playing of recorded music between 08:00 and 23:00 on any day on premises authorised to sell alcohol for consumption on those premises, provided that the audience does not exceed 500.
  - o any playing of recorded music between 08:00 and 23:00 on any day, in a church hall, village hall, community hall, or other similar community premises, that is not licensed by a premises licence to sell alcohol, provided that (a) the audience does not exceed 500, and (b) the organiser gets consent for the performance from a person who is responsible for the premises.
  - o any playing of recorded music between 08:00 and 23:00 on any day, at the non-residential premises of (i) a local authority, or (ii) a school, or (iii) a hospital, provided that (a) the audience does not exceed 500, and (b) the organiser gets consent for the performance on the relevant premises from: (i) the local authority concerned, or (ii) the school proprietor or (iii) the health care provider for the hospital.

Continued from previous page...

- Dance: no licence is required for performances between 08.00 and 23.00 on any day, provided that the audience does not exceed 500. However, a performance which amounts to adult entertainment remains licensable.
- Cross activity exemptions: no licence is required between 08.00 and 23.00 on any day, with no limit on audience size for:
  - o any entertainment taking place on the premises of the local authority where the entertainment is provided by or on behalf of the local authority;
  - o any entertainment taking place on the hospital premises of the health care provider where the entertainment is provided by or on behalf of the health care provider;
  - o any entertainment taking place on the premises of the school where the entertainment is provided by or on behalf of the school proprietor; and
  - o any entertainment (excluding films and a boxing or wrestling entertainment) taking place at a travelling circus, provided that (a) it takes place within a moveable structure that accommodates the audience, and (b) that the travelling circus has not been located on the same site for more than 28 consecutive days.

#### Section 21 of 21

#### PAYMENT DETAILS

This fee must be paid to the authority. If you complete the application online, you must pay it by debit or credit card.

Premises Licence Fees are determined by the non-domestic rateable value of the premises.

To find out a premises non domestic rateable value go to the Valuation Office Agency site at [http://www.voa.gov.uk/business\\_rates/index.htm](http://www.voa.gov.uk/business_rates/index.htm)

Band A - No RV to £4300 £100.00

Band B - £4301 to £33000 £190.00

Band C - £33001 to £8700 £315.00

Band D - £87001 to £12500 £450.00\*

Band E - £125001 and over £635.00\*

\*If the premises rateable value is in Bands D or E and the premises is primarily used for the consumption of alcohol on the premises then you are required to pay a higher fee

Band D - £87001 to £12500 £900.00

Band E - £125001 and over £1,905.00

There is an exemption from the payment of fees in relation to the provision of regulated entertainment at church halls, chapel halls or premises of a similar nature, village halls, parish or community halls, or other premises of a similar nature. The costs associated with these licences will be met by central Government. If, however, the licence also authorises the use of the premises for the supply of alcohol or the provision of late night refreshment, a fee will be required.

Schools and sixth form colleges are exempt from the fees associated with the authorisation of regulated entertainment where the entertainment is provided by and at the school or college and for the purposes of the school or college.

If you operate a large event you are subject to ADDITIONAL fees based upon the number in attendance at any one time

Capacity 5000-9999 £1,000.00

Capacity 10000 -14999 £2,000.00

Capacity 15000-19999 £4,000.00

Capacity 20000-29999 £8,000.00

Capacity 30000-39000 £16,000.00

Capacity 40000-49999 £24,000.00

Capacity 50000-59999 £32,000.00

Capacity 60000-69999 £40,000.00

Capacity 70000-79999 £48,000.00

Capacity 80000-89999 £56,000.00

Capacity 90000 and over £64,000.00

\* Fee amount (£)

190.00

#### DECLARATION

Continued from previous page...

[Applicable to individual applicants only, including those in a partnership which is not a limited liability partnership] I understand I am not entitled to be issued with a licence if I do not have the entitlement to live and work in the UK (or if I am subject to a condition preventing me from doing work relating to the carrying on of a licensable activity) and that my licence will become invalid if I cease to be entitled to live and work in the UK. The DPS named in this application form is entitled to work in the UK (and is not subject to conditions preventing him or her from doing work relating to a licensable activity) and I have seen a copy of his or her proof of entitlement to work, if appropriate

Ticking this box indicates you have read and understood the above declaration

This section should be completed by the applicant, unless you answered "Yes" to the question "Are you an agent acting on behalf of the applicant?"

\* Full name

\* Capacity

\* Date  /  /   
dd mm yyyy

Once you're finished you need to do the following:

1. Save this form to your computer by clicking file/save as...
  2. Go back to <https://www.gov.uk/apply-for-a-licence/premises-licence/epping-forest/apply-1> to upload this file and continue with your application.
- Don't forget to make sure you have all your supporting documentation to hand.

**IT IS AN OFFENCE LIABLE TO SUMMARY CONVICTION TO A FINE OF ANY AMOUNT UNDER SECTION 158 OF THE LICENSING ACT 2003, TO MAKE A FALSE STATEMENT IN OR IN CONNECTION WITH THIS APPLICATION**

**IT IS AN OFFENCE UNDER SECTION 24B OF THE IMMIGRATION ACT 1971 FOR A PERSON TO WORK WHEN THEY KNOW, OR HAVE REASONABLE CAUSE TO BELIEVE, THAT THEY ARE DISQUALIFIED FROM DOING SO BY REASON OF THEIR IMMIGRATION STATUS. THOSE WHO EMPLOY AN ADULT WITHOUT LEAVE OR WHO IS SUBJECT TO CONDITIONS AS TO EMPLOYMENT WILL BE LIABLE TO A CIVIL PENALTY UNDER SECTION 15 OF THE IMMIGRATION, ASYLUM AND NATIONALITY ACT 2006 AND PURSUANT TO SECTION 21 OF THE SAME ACT, WILL BE COMMITTING AN OFFENCE WHERE THEY DO SO IN THE KNOWLEDGE, OR WITH REASONABLE CAUSE TO BELIEVE, THAT THE EMPLOYEE IS DISQUALIFIED**



DPS Consent

**Consent of individual to being specified as premises supervisor**

Yavuz Coban

-----

Of

[REDACTED] Enfield N9 9HA

-----  
*[home address of prospective premises supervisor]*

hereby confirm that I give my consent to be specified as the designated premises supervisor in relation to the application for

New premises licence application

-----  
*[type of application]*

by

Arin Restaurant LTD

-----  
*[name of applicant]*

relating to a premises licence

**Not applicable**

-----  
*[number of existing licence, if any]*

for

Abbey Grill, 18 Sun Street, Waltham Abbey, Essex EN9 1EE

-----  
*[name and address of premises to which the application relates]*

and any premises licence to be granted or varied in respect of this application made by

Arin Restaurant LTD

-----  
*[name of applicant]*

concerning the supply of alcohol at

Abbey Grill, 18 Sun Street, Waltham Abbey, Essex EN9 1EE

-----  
*[name and address of premises to which application relates]*

I also confirm that I am entitled to work in the United Kingdom and am applying for, intend to apply for or currently hold a personal licence, details of which I set out below.

Personal licence number

LN/ [REDACTED]

-----  
*[insert personal licence number, if any]*

Personal licence issuing authority

London Borough of Enfield

-----  
*[insert name and address and telephone number of personal licence issuing authority, if any]*

Signed

Name (please print)

-----  
YAVUZ COBAN [REDACTED]

Date

-----  
16 September 2020

# Plan of the premises

ABBAY GRILL,  
18 SUN STREET  
WALTHAM ABBEY

GROUND FLOOR

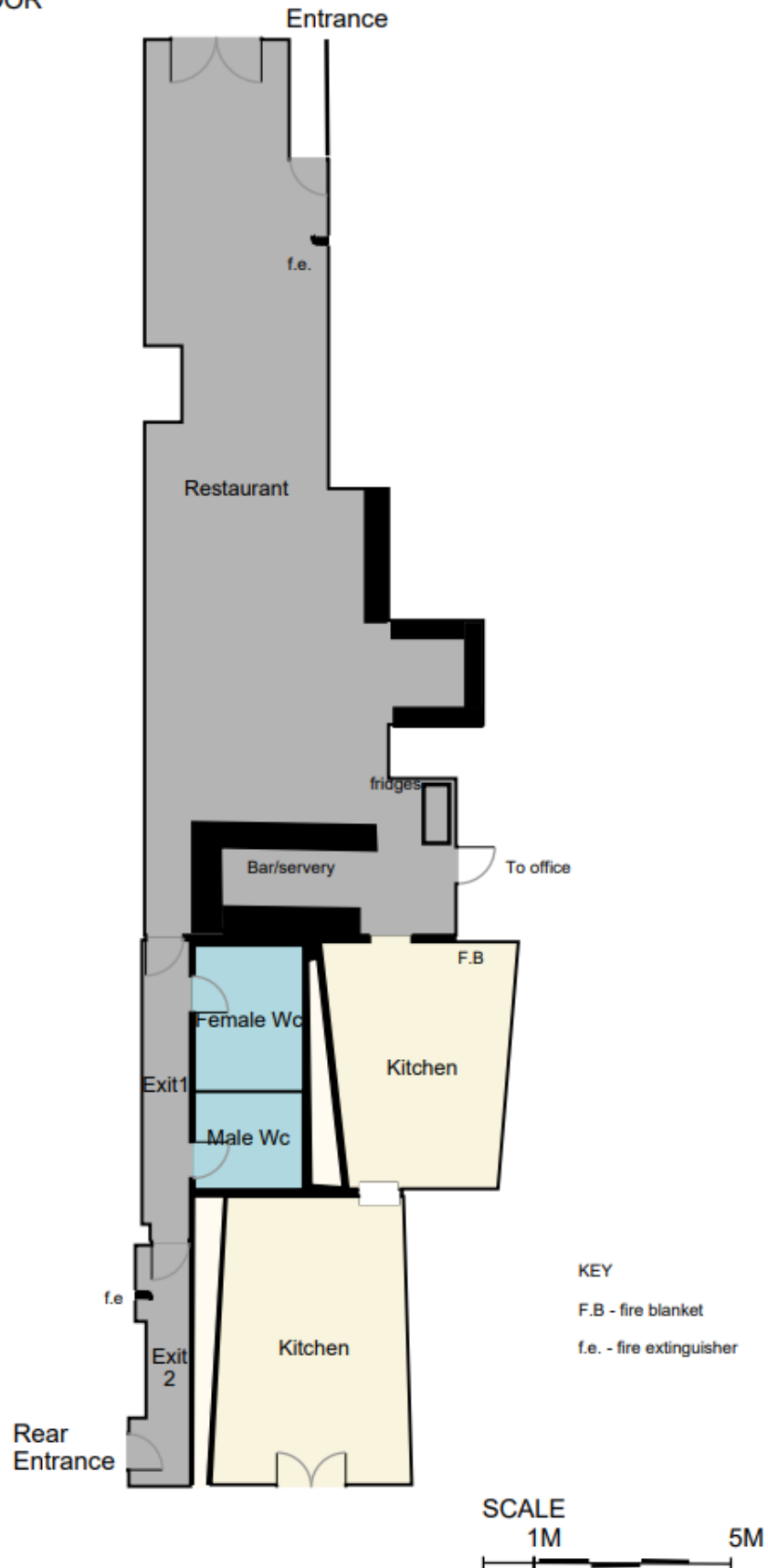

## Copy of blue notice

### LICENSING ACT 2003 Notice of Application for New Premises Licence

We ARIN RESTAURANT LIMITED, hereby make an application for a New Premises Licence in respect of Abbey Grill, 18 Sun Street, Waltham Abbey, Essex EN9 1EE.

The proposed licensable activities applied for are:

Sale of Alcohol – Mondays to Sundays 10:00 to 00:00 each day on and off the premises.

Late Night Refreshment – Mondays to Sundays 23:00 to 00:00 each day.

Such further times and on such terms as more specifically set out in the application or as may be agreed.

Interested parties and responsible authorities may make representations to the Licensing Authority Epping Forest District Council. All such representations shall be made in writing on or before 29<sup>th</sup> October 2020

Representations should be sent to the Licensing Unit, Civic Offices, Epping Forest District Council, High Street, Epping, Essex, CM16 4BZ

A record of the application, and the statutory register of the Licensing Authority, may be inspected at the Council's office address given above, between 10.00am and 4.00pm on Mondays to Fridays. (subject to prior appointment only) Or viewed on the Council website [www.eppingforestdc.gov.uk/licensing](http://www.eppingforestdc.gov.uk/licensing).

It is an offence knowingly or recklessly to make a false statement in connection with an application, and the maximum fine for which a person is liable on summary conviction is unlimited

Dated 1<sup>st</sup> October 2020

Announcements - Public Notices



Epping Forest District Council

Planning Affecting a Conservation Area or Setting of a listed building

EPF/1873/20 Land adj. George House High Street Ongar CM5 9JG Variation of condition 2 'Plan no's' on planning approval EPF/2786/17 EPF/2019/20 6 Victoria Cottages Horseshoe Hill Waltham Abbey EN9 3SP Loft conversion with rear dormer, Juliet balcony and roof windows to front and EPF/2131/20 Single storey and part two storey rear extensions

Major Application or of wider concern

EPF/2020/20 Garage site Ladyfields Loughton IG10 3RP Redevelopment to provide flats and houses 16 units in total EPF/2036/20 Roydon Marina Village High Street Roydon CM19 5EJ Extension to provide additional 168 berths, 99 parking spaces, additional facilities, widening and improvement to existing vehicular and pedestrian access.

Any representations must be sent to the Head of Planning and Economic Development by: 06/11/2020

Comment online at www.eppingforestdc.gov.uk/iPlan,

LICENSING ACT 2003 Notice of Application for a New Premises Licence

We, Anir Restaurant Limited, hereby make an application for a New Premises Licence in respect of Abbey Grill, 18 San Street, Waltham Abbey, Essex EN9 1EE. The proposed licensable activities spotted for are: Sale of Alcohol - Mondays to Sundays 10:00 to 00:00 each day on and off the premises. Late Night Refreshment - Mondays to Sundays 23:00 to 00:00 each day. Such further times and on such terms as more specifically set out in the application or as may be agreed. Interested parties and responsible authorities may make representations to the Licensing Authority Epping Forest District Council. All such representations shall be made in writing on or before 29th October 2020. Representations should be sent to the Licensing Unit, Civic Offices, Epping Forest District Council, High Street, Epping, Essex, CM16 4EZ. A record of the application, and the statutory register of the Licensing Authority, may be inspected at the Council's office address given above between 10:00am and 4:00pm on Mondays to Fridays, (subject to prior appointment only). Or viewed on the Council website www.eppingforestdc.gov.uk/licensing.

It is an offence knowingly or recklessly to make a false statement in connection with an application, and the maximum fine for which a person is liable, on summary conviction is unlimited. Dated 1st October 2020

Notice of Application for a New Premises Licence under the Licensing Act 2003

Office is given this day Friday 9th October 2020. The proposed licensable activities spotted for are: Sale of Alcohol - Mondays to Sundays 10:00 to 00:00 each day on and off the premises. Late Night Refreshment - Mondays to Sundays 23:00 to 00:00 each day. Such further times and on such terms as more specifically set out in the application or as may be agreed. Interested parties and responsible authorities may make representations to the Licensing Authority Epping Forest District Council. All such representations shall be made in writing on or before 29th October 2020. Representations should be sent to the Licensing Unit, Civic Offices, Epping Forest District Council, High Street, Epping, Essex, CM16 4EZ. A record of the application, and the statutory register of the Licensing Authority, may be inspected at this office during office hours. Anyone wishing to oppose this application must give written notice to the Licensing Office within 28 days of this notice. It is an offence knowingly or recklessly to make a false statement in connection with an application which could lead to a fine on summary conviction (maximum £5000). Applicant's Agent: Knight Training (UK) Ltd. 0330 899 3199 info@knighttraining.co.uk knighttraining

Working together to help businesses grow

819k+ pages viewed every month.\*



## Objection from Essex Police

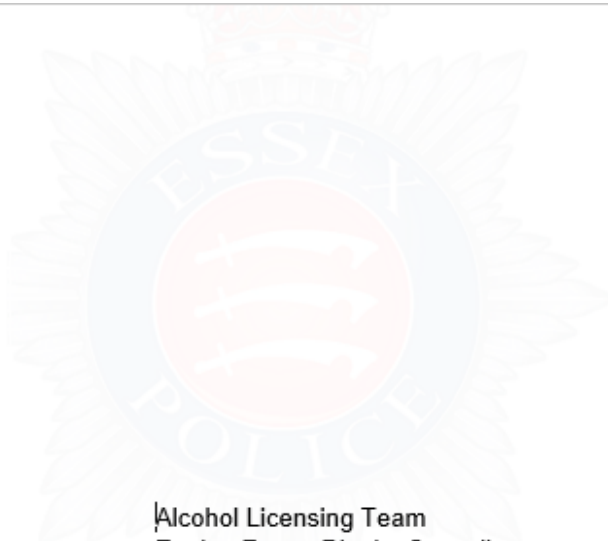

Alcohol Licensing Team  
Epping Forest District Council  
Civic Office  
323 High Street  
Epping  
CM16 4BZ

22 October 2020

### **POLICE OBJECTION NOTICE to application for a Premises Licence Licensing Act 2003**

Name of Premises User: Abbey Grill

Address of Premises: 18 Sun Street, Waltham Abbey, EN9 1EE

On the 5<sup>th</sup> October 2020 Essex Police received the above application with a consultation period ending on 29<sup>th</sup> October 2020.

The Police are satisfied that the allowing the premises to be used in accordance with the notice(s) would undermine both the prevention of crime and disorder and the public safety objectives.

The reasons for being so satisfied are the same as when Abbey Grill were taken to summary review on 7<sup>th</sup> July 2020 and their alcohol licence was revoked. The evidence that this decision was based on is detailed below.

#### **23rd May 2020**

VICTIM 1 was in Waltham Cross, Hertfordshire, when a car approached him and the occupants asked him to get in the car, he recognised these males. They drove around for some time before arriving at Abbey Grill. VICTIM 1 entered the restaurant where he was met by OFFENDER 1.

OFFENDER 1 told VICTIM 1 he needed to go upstairs, which he did. Once there, OFFENDER 2 was waiting for him. OFFENDER 2 was sat at a table with a sawn-off shot gun on it.

---

Essex Police Licensing Unit, ~~Blyths~~ Meadow Braintree, Essex CM7 3DJ

[Licensing.applications@essex.police.uk](mailto:Licensing.applications@essex.police.uk) 01245 452035

In an emergency always dial 999. For non-emergencies dial 101

[www.essex.police.uk](http://www.essex.police.uk)

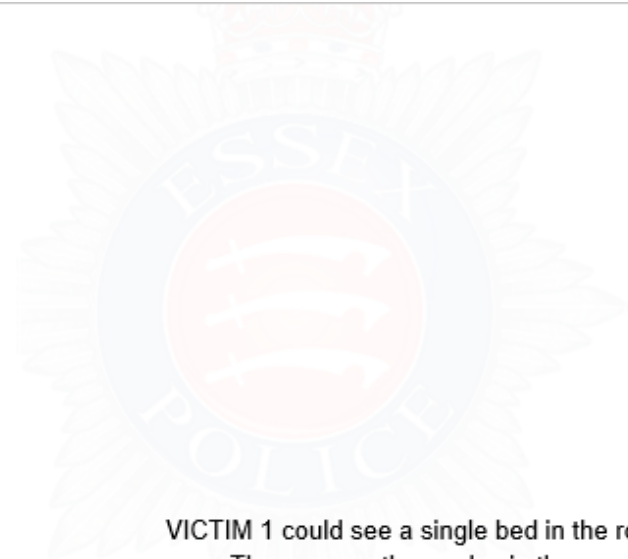

VICTIM 1 could see a single bed in the room, and thought he was dead, and his life was over. There were other males in the room who are unidentified. VICTIM 1 was then hit on the head with a small bat and he fell on the bed. OFFENDER 1 began to slap and punch the male. This was recorded on a mobile phone.

A knife was then held to the throat of VICTIM 1 and threats made to his and his family's lives unless £70000 was paid.

The assaults continued for approximately one hour, and the gun was pointed at him the whole time by OFFENDER 2.

#### **25th May 2020**

Two people were detained by staff at Abbey Grill. Metropolitan Police were contacted by a relative of the victim asking for money. It is alleged the persons were stealing cooking oil from the premises when they were taken into the premises and held against their will. Money was demanded in reparation and their identity documents taken.

#### **6th June 2020**

A firearms warrant was executed at Abbey Grill and other associated premises. Suspects in relation to the incident on 23rd May 2020 were arrested and drugs were seized.

OFFENDER 1 and OFFENDER 2 were among those arrested. Others arrested include those who transported VICTIM 1 to Abbey Grill, and those present at the premises on 23rd May 2020 (OFFENDER 3 and OFFENDER 4). OFFENDER 1 has been charged with assault occasioning actual bodily harm, and false imprisonment. OFFENDER 2 has been charged with possession of a firearm with intent to cause fear or violence, assault occasioning actual bodily harm, false imprisonment and possession of class A drugs. OFFENDER 3 was charged with conspire to blackmail, assault occasioning actual bodily harm, and false imprisonment.

OFFENDER 4 was charged with conspire to blackmail, assault occasioning actual bodily harm, false imprisonment, and possession of a taser.

---

Essex Police Licensing Unit, ~~Rlyths~~ Meadow Braintree, Essex CM7 3DJ

[Licensing.applications@essex.police.uk](mailto:Licensing.applications@essex.police.uk) 01245 452035

In an emergency always dial 999. For non-emergencies dial 101

[www.essex.police.uk](http://www.essex.police.uk)



#### **8th June 2020**

PERSON 2 reported an attempted burglary at Abbey Grill, three people trying to gain entry to the premises

#### **9th June 2020**

Several males attended Abbey Grill. They entered the premises with banners saying, 'under new management'. They told PERSON 3 they had spoken to the owner who told them to take back control.

#### **10th June 2020**

PERSON 3 attended the police station stating the males from 9th June had made threats to kill her. Since PERSON 3 came to the attention of police it has come to light that they are 15 years old and have been working at Abbey Grill since February 2020. She was asked about her involvement with OFFENDER 1 as she refers to him as "UNCLE". She stated he was a family friend and "UNCLE" is just a term she refers to him as. She was asked if there was anything more to the relationship and she stated no.

PERSON 3 attended Abbey Grill with police on 10th June 2020 where she cashed the till up and removed all the takings, she also has access to all of the restaurants CCTV on her mobile phone, clearly indicating her role there is simply more than just turning up for part time work. She also arranged for OFFENDER 1's dog to be taken to her grandmothers address so she could look after it while he is on remand. It is unclear as to what exploitation she is involved in but she is clearly involved in the business on a level more than part-time work and though only 15 years of age was expected to serve alcohol.

#### **7<sup>th</sup> September 2020**

Essex Police and Epping Forest licensing officers attended the premises and met:

- Mr Hasan PARLAK the new director of Aaron restaurant Ltd
- Mr Yavuz COBAN proposed new DPS with previous knowledge and experience at the premises.
- [REDACTED] - Currently seeking lease hold for the premises.

---

Essex Police Licensing Unit, Blyths Meadow Braintree, Essex CM7 3DJ

[Licensing.applications@essex.police.uk](mailto:Licensing.applications@essex.police.uk) 01245 452035

In an emergency always dial 999. For non-emergencies dial 101

[www.essex.police.uk](http://www.essex.police.uk)

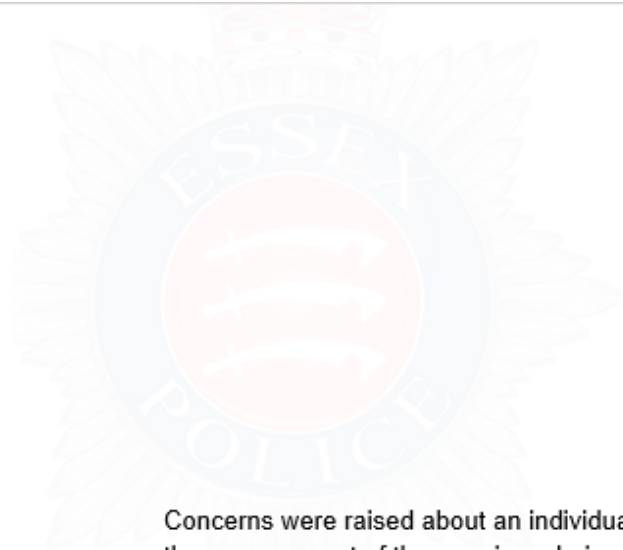

Concerns were raised about an individual [REDACTED] who had been involved in the management of the premises during the incidents detailed above. All parties at this meeting gave assurances that [REDACTED] had no connection with the premises. It was described that [REDACTED] had originated from the same village as Mr PARLAK in Turkey and he was in no other way connected to the premises.

**6<sup>th</sup> October 2020**

Essex Police information reported that [REDACTED] has been charged with a serious offence within the Metropolitan Police district and if found guilty could face 10 years imprisonment [REDACTED] has Court bail conditions to live and sleep each night at 18 Sun Street, Waltham Abbey dated 19<sup>th</sup> September 2020. This report also shows Mr [REDACTED] declared his occupation as a restaurateur. [REDACTED] has a clear connection with the premises seeking to obtain a premises licence and that his presence on the premises clearly undermines the licensing objective of preventing Crime & Disorder.

**15<sup>th</sup> October 2020**

In line with guidance point 8.48 working in partnership with the applicant. I spoke with the applicants representative Mr Sutherland and expressed my concerns about [REDACTED] [REDACTED] presences at the premises.

**20<sup>th</sup> October 2020**

[REDACTED] contacted Police and confirmed that he is at the premises and raised an issue in relation to his bail conditions.

**23<sup>rd</sup> October 2020**

At the time of submission of this document the applicants have not responded to Police concerns about [REDACTED] connection to the premises.

It is the opinion of Essex Police is that the premises are managed or controlled by persons with no connection to the previous licence holder. The same management regime is still in

---

Essex Police Licensing Unit, ~~Blyths~~ Meadow Braintree, Essex CM7 3DJ

[Licensing.applications@essex.police.uk](mailto:Licensing.applications@essex.police.uk) 01245 452035

In an emergency always dial 999. For non-emergencies dial 101

[www.essex.police.uk](http://www.essex.police.uk)



control of the restaurant that gave rise to the revocation of the alcohol licence and in effect, nothing has changed.

Yours faithfully

Ronan McManus  
County Licensing Officer  
Pp Chief Officer of Police

## Response from Environmental Health

**From:** Katarzyna Bray  
**Sent:** 28 October 2020 12:40  
**To:** Hannah Gould <[hgould@eppingforestdc.gov.uk](mailto:hgould@eppingforestdc.gov.uk)>  
**Subject:** Abbey Grill alcohol licence consultation

Hi,  
Ref Abbey Grill 18 a Sun Street Waltham Abbey EN9 1EE- alcohol licence consultation  
We don't have objections for the premise to serve alcohol however it is worth mentioning that we received 3 Covid related complaints in the last few months.

1. WK/202033796 (28<sup>th</sup> August 2020) and WK/202033775 (14<sup>th</sup> September 2020) - Both complaints were similar. The complainants stated that the restaurant did not follow safety rules to be Covid secure. The tables were spaced out too close, staff were not keeping their distance. Visited the restaurant, most measures to manage exposure to Covid were in place. I requested Covid secure risk assessment. Written risk assessment was submitted.
2. WK/October- 15<sup>th</sup> October 2020- anonymous complaint from a resident who lives next door. The complainant did not want to disclose her details. She advised that the restaurant was open after 10pm. The music was very loud, the doors were open and they took all the tables and chairs and put them outside in Sun Street. She had to close her window to go to sleep. She was woken up at 2am in the morning by loud music and screaming. She advised that the person called Irfan has been released from prison and is back in the restaurant. She heard him screaming last night. She believes that the restaurant is causing loads of problems and should not have an alcohol licence. I advised her to call the police if this happens again. Information was recorded on M3 as intelligence.

Kind regards

**Katarzyna Bray**  
**Environmental Health Officer**  
**Business and Corporate Team**

Epping Forest District Council  
Commercial & Regulatory Services  
Business & Corporate Team  
Civic Offices  
323 High Street  
Epping  
Essex  
CM16 4BZ

## Response from Essex County Fire & Rescue Service

Abbey Bar & Grill, 18 Sun Street, Waltham Abbey, Essex, EN9 1EE - new premises licence application - responsible authorities & Cllrs



Angus Neale <angus.neale@essex-fire.gov.uk>

To Hannah Gould

Reply

Reply All

Forward



Thu 08/10/2020 15:51

 You replied to this message on 08/10/2020 15:59.  
If there are problems with how this message is displayed, click here to view it in a web browser.

Hi Hannah,  
FYI

I visited the above premises with regard to the above premises to familiarise myself with the layout.

Whilst there I noticed that

- The double doors giving access on to Sun Street indicated on the plan were not in use and obstructed from opening by dining tables and seating.
- The front and rear final exit doors were opening against the direction of flow.

Under the **Regulatory Reform (Fire Service) order 2005** I spoke to the director, a Mr Hasam Parlak, who informed me he would have the doors reversed to open in the direction of exit flow. I advised that numbers should be limited to a maximum of 60 persons until the work had been carried out. He agreed with this as it was in line with his "Covid 19" restrictions of 50 persons.

Mr Parak spoke very little English, but I am confident that he understood my requests through a member of staff who translated.

I will reply to the application shortly

Thanks  
Angus

Regards

Angus Neale  
Watch Manager



E-mail: [southwestgroupsdp@essex-fire.gov.uk](mailto:southwestgroupsdp@essex-fire.gov.uk)

---

Protection (South West Group)  
Fire Safety Officer  
Essex County Fire and Rescue Service  
Basildon & Brentwood Service Delivery  
Fire Station  
Broadmayne  
Basildon  
SS14 1EH





Essex County  
Fire & Rescue Service

Jo Turton  
Chief Fire Officer / Chief Executive

Robert Sutherland  
Licenses-r-us Ltd.,  
18 Sun Street  
Waltham Abbey  
EN9 1EE

South West Group Service Delivery Point  
Basildon Fire Station  
Broadmayne  
Basildon  
SS14 1EH

Enquiries to: Fire Prevention Officer Angus Neale  
[REDACTED]  
[southwestgroupsdp@essex-fire.gov.uk](mailto:southwestgroupsdp@essex-fire.gov.uk)

Our Ref: 27622  
Your Ref: N/A  
Date: 9<sup>th</sup> October 2020

Dear Sir,

**LICENSING ACT 2003**  
**THE REGULATORY REFORM (FIRE SAFETY) ORDER 2005**  
**Premises: Abbey Bar and Grill, 18 Sun Street Waltham Abbey EN9 1EE**

Receipt is acknowledged of the above consultation(s), which will be audited by the Essex Police, Fire and Crime Commissioner Fire and Rescue Authority.

Should there be any significant concerns regarding the application(s) you will be notified in due course.

Please quote our reference number in any future correspondence.

Yours faithfully

[REDACTED]

C A Neale  
Protection

Cc M/s Hannah Gould, Licensing Officer, Epping Forest District Council, Civic Offices, 323 High Street,  
Epping CM16 4BZ



# Map of the area



